

COUNCIL FUNDED HIGHWAY WORKS
SCALE 1:1000

LEGEND:

- SIGNALISED PEDESTRIAN CROSSING UNLESS NOTED OTHERWISE
- RAMP
- COUNCIL FUNDED HIGHWAY WORKS
- KERB REALIGNMENT - LOCALISED
- FOOTPATH/CARRIAGEWAY REINSTATEMENT TO SUIT
- CARRIAGEWAY CONSTRUCTION / RESURFACING
- FOOTPATH CONSTRUCTION / RESURFACING
- CARRIAGEWAY WIDENING TO EXISTING LEVELS EXCLUDED FROM COUNCIL FUNDED WORKS
- AREAS OF RAISED CARRIAGEWAY
- ROAD MARKINGS
- PROPOSED NEW CAR PARK VMS

This drawing should not be scaled. Dimensions to be verified on site. Any discrepancies should be referred to the Engineer prior to work being put in hand.

This drawing is the property of Waterman Transport & Development Limited, and the drawing is issued on the condition that it is not copied reproduced, retained or disclosed to any unauthorised person, either wholly or in part without the consent in writing of Waterman Transport & Development Limited
Pickfords Wharf, Clink Street, London SE1 9DG t 020 7928 7888 f 020 7902 0992

GENERAL NOTES

Rev	Date	Description	By
L11	09.04.14	EXIST CAR PARK VMS CHANGED TO PROPOSED VMS	B.M.
L10	03.04.14	LEGEND AMENDED	B.M.
L09	29.10.13	MINOR CHANGES TO ROAD LAYOUT	B.M.
L08	27.08.13	FORMER INFORMAL CROSSING CHANGED TO SIGNALISED CROSSING	LS
L07	05.08.13	INFORMAL CROSSING POINT ADDED, MINOR AMENDMENT TO KERB	LS
L06	25.07.13	ADDED PAVING AT SOUTH SIDE OF EASTGATE	B.M.
L05	12.03.13	DRAWING AMENDED TO SUIT RECENT CHANGES	B.M.
L04	03.10.12	TITLE CHANGED, PHASE 1 ADDED	B.M.
L03	01.10.12	ACCESS TO MARKET AMENDED	B.M.
L02	28.09.12	DRAWING AMENDED	B.M.
L01	27.09.12	FIRST ISSUE	B.M.

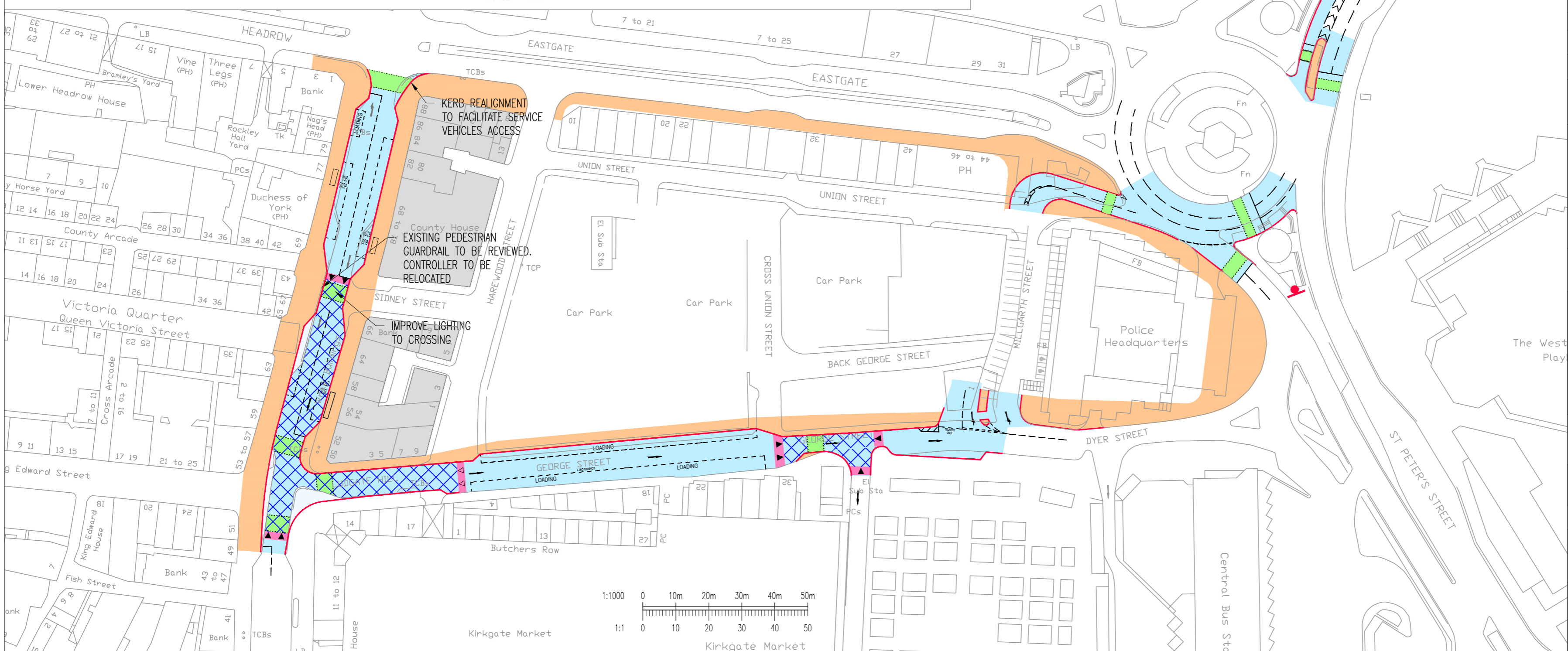

Amendments

Project
EASTGATE QUARTERS, LEEDS

Title
**PLAN 8
SECTION 278 WORKS
(PHASE 1)**

Client
HAMMERSON



Pickfords Wharf Clink Street London SE1 9DG
t 020 7928 7888 f 020 7928 3033
mail@waterman-group.co.uk www.watermangroup.com

LEGAL

Designed by	-	Checked by	M.C.	Project No	34992
Drawn by	B.M.	Date	Sept. 2012	Computer File No	
Scales @ A2		1:1000 @ A2		work to figured dimensions only	

Publisher	Zone	Category	Number	Revision
WTD	SA	S278	008	L11